

INSTALLATION INSTRUCTIONS (5G) STONE PLASTIC COMPOSITE (SPC) PLANK FLOORING.

Tools and materials required

- Safety glasses
- Measuring tape
- Spacers
- Utility knife
- Straight edge
- Rubber mallet
- Hand Saw OR Electric Saw

Please read this instruction carefully before installation.

Suitable substrates

SPC flooring can be installed on most existing floors, wooden, PVC and concrete floors. All carpeting and padding need to be removed. Make sure that the surface is clean, dry and level within 3/16" in 10 ft. (4.7mm over a 3M span). Supporting floors must be rigid as too much deflection can result in a failed installation.

WOODEN SUBFLOORS

- If this flooring is intended to be installed over an existing wooden floor, it is recommended to repair any loose boards or squeaks before you begin the installation.
- Nail or screw every 6" (15 cm) along joists to avoid squeaking.
- Wooden subfloors must be tight, secure, level and without movement.
- Basements and crawl spaces must be dry. Use of a 6-mil black polyethylene is required to cover 100% of the crawl space earth.
- We recommend laying on wooden floors crossways to the existing floorboards.

Concrete substrates

SPC flooring may be installed over on grade, above grade or below grade concrete subfloors.

Concrete floors shall be constructed in accordance to local construction standards. Concrete shall have a minimum compressive strength of 3500 psi.

ALTHOUGH THIS SPC FLOOR IS WATERPROOF, IT IS NOT DESIGNED TO BE USED AS A MOISTURE BARRIER.

Installation of a moisture vapour-barrier is recommended prior to pouring of on or below grade slabs. Moisture vapour transmission shall not exceed 3 lbs / 1000 sq.ft. / 24 hours per ASTM F-1869. Moisture may also be tested according to ASTM F 2170; when tested according to this method, the internal relative humidity shall not exceed 75%.

Substrate preparation

- All substrates must be dry, clean, smooth level, free from all existing adhesive residues, and free from movement or deflection.
- The substrate must be level within 3/16" in 10 ft. (4.7mm over a 3M span).

- Fill and level all plywood seams and concrete cracks, construction joints, control joints, depressions, grooves or other irregularities using appropriate materials.
- Sweep and/or vacuum substrate to remove all dust debris.

Prior to installation

- Carefully check flooring material for any defects. Contact your supplier immediately if any defect is found.
- Inspect all planks for visible defects and damage before and during installation.

DO NOT INSTALL ANY DAMAGED PLANKS. THE MANUFACTURER WILL NOT ACCEPT RESPONSIBILITY FOR ANY CLAIMS ON FLOORING INSTALLED WITH OBVIOUS DEFECTS.

During installation, inspect the groove area and remove any debris that may prevent proper assembly of planks.

- Room temperature shall be no less than 65 ° F / 18.3°C for 24 hours before, during and after installation.
- Remove all existing mouldings.
- Undercut doorway mouldings to the thickness of the flooring.
- **SPC flooring is not recommended to be installed under large windows where the flooring is exposed to intense direct sunlight for long periods of time.**
- Cartons must be stored horizontally at all times.
- Protect carton corners from damage.
- This Rigid core flooring is a floating floor and should not be glued or nailed to the substrate.
- SPC flooring is intended for indoor use only.
- Determine in which direction the planks will be installed. To make the room appear larger or if installing in very small rooms or hallways, it is preferable to lay the planks parallel to the longest room dimensions.
- Do not install cabinets on planks.
- Carefully measure the room to determine that it is square and also to determine the width of the last row of planks is less than 2" (50 mm), excluding the tongue, the width of the first row of planks will have to be cut accordingly.
- A minimum 5/16" (8 mm) expansion space is required around the perimeter of the room and all vertical objects
- Ensure that all boxes are of the same product and mix planks from different boxes for best results.

Installation

THIS PRODUCT NEEDS ROOM TO EXPAND AND CONTRACT. AT NO POINT SHOULD YOU ATTACH THE FLOOR TO ANY VERTICAL SURFACE.

1. Starting with a full plank/tile along the wall, calculate how many widths there are across the room. If this means there will be a row of narrow planks/tiles along the opposite wall, cut the first row accordingly. Install this product with the tongue side/cut edge facing the wall. Install 3/16" (5 mm) spacers between the plank/tile and wall (Fig. 1).

2. Install the first row, ensuring the short edges are clicked together (Fig. 2).

3. Using a knife and straight edge, cut the last piece of the row to size making sure that there is 5/16" (8 mm) gap between the end of the row and the wall.

4. Start the second row by clicking the tongue into the groove holding the plank at an angle (approximately 30°), then tap the plank/tile firmly into the groove of the first row. Install the next plank/tile by easing the tongue and groove together on the long side (Fig. 3). Tiles and planks should be installed 'off-set' such that four corners never meet (Fig. 3a and Fig. 3b).

5. Continue to install planks/tiles across the room until the row is complete using a hand roller to assist (Fig 4). Only if necessary, use a rubber mallet and an offcut of the product to gently tap the product together. A pull bar can be used to pull the product together around the edges of the room (Fig. 5).

6. Repeat steps 4 and 5 until the installation is complete.

7. Under door frames: If plank/tile cannot be lifted use an adapted tapping block (off-cut of material) and mallet to carefully tap the plank/tile together flat on the floor (Fig. 6).

8. When installing around corners/convex corners, or complex profiles, mark the shape on the plank/tile and cut using a saw.

9. Once the floor is installed, remove the spacers; sweep the floor with a soft brush. Fix the skirting/base boards or suitable edge trim (available from your local distributor) to cover the expansion gaps. These should be attached to the wall and not the floor, such that the product remains free to expand (Fig. 7 & 8).

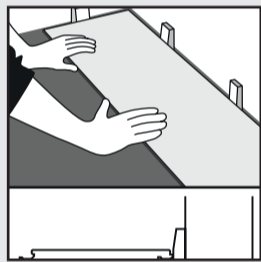

Fig. 1

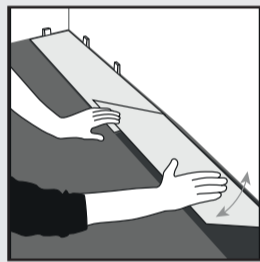

Fig. 2

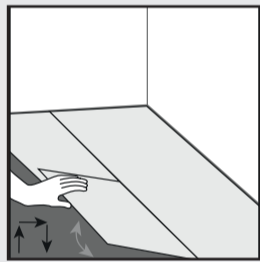

Fig. 3

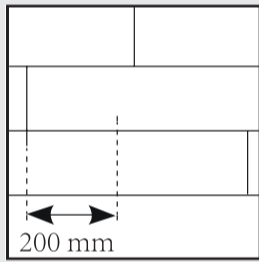

Fig. 3a
Wood effect: Planks should be fitted with random staggered joints with a minimum 200 mm between short ends.

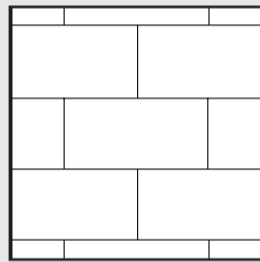

Fig. 3b
Stone effect: Tiles should be fitted in a 'brick' pattern (off-set).

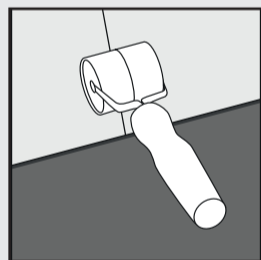

Fig. 4

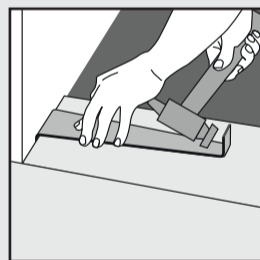

Fig. 5



Fig. 6

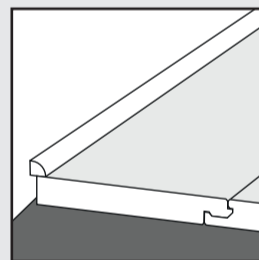

Fig. 7

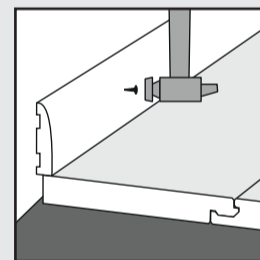

Fig. 8

Finishing the installation

- After all planks have been installed, remove spacers from perimeter of room.
- Install transition mouldings. Do not fasten any mouldings through the flooring.
- Pre-drill and install quarter round or baseboard moulding. Moulding must be sufficient size to cover the 5/16" (8 mm) space and must be fastened to the wall, not to the flooring.
- Use furniture moving pad to cover the top of the flooring when moving heavy furniture or appliances into position.
- Use proper floor protectors under the legs of furniture.
- Post installation temperature must be maintained between 65° F / 18.3 C and 100° F / 37.8 C . Relative humidity must be maintained between 40% and 70%.

Maintenance

Please follow the recommendations in this guide to retain the fresh look and protect the finish. After installing the floor, we recommend cleaning to remove loose dirt or debris that may have been introduced during the installation process. Also, in order to protect the flooring surface from abrasive dirt and debris we recommend installing an effective barrier system to limit the amount of moisture, dirt, and grit that may enter the flooring area. Please check any new cleaning agents on a small test patch of the floor in an inconspicuous area, and avoid using harsh cleaners or ammonia based cleaning products.

1. First, sweep and vacuum the floor surface to ensure removal of all loose dust, dirt, and debris. Using a mop scrub the flooring surface. Use warm, clean water, ring several times or as needed, the use a dry mop or wet vacuum to remove the water and allow to dry.

2. Avoid exposure to direct sunlight for prolonged periods of time. During peak sunlight hours, use drapes or blinds to minimize the direct sunlight on the SPC flooring. Most types of flooring will be affected by continuous strong sunlight. In addition, excessive temperatures are not good for resilient floors. Some natural ventilation or intermittent air conditioning in vacant homes should be considered. Long term continuous inside temperatures over 95°F combined with strong direct sunlight will damage the flooring and cause the installation to fail.

3. Do not wax your SPC flooring. The surface of your floor is very dense and nonporous, which prevents wax from penetrating and thus builds up a bed for yellowing and dirt collection. The same non-porous feature also provides all the protection against wear and staining that you will need.

4. Do not use soap based detergents or abrasive cleaners.

Damp mop as needed with cleaners that are recommended for vinyl flooring.

To avoid possible permanent indentation or damage, proper floor protection devices must be used under furniture and appliances. Exercise care when removing and replacing furniture or appliances.

5. If your floor has been exposed to excessive amounts of water due to flooding, simply remove the water as quickly as possible using a water pump, fans and a dehumidifier. A dehumidifier should be promptly turned on in the room to reduce the moisture levels back to normal. Do not dry the room below the normal moisture level that existed previously.

UNDER FLOOR HEATING COMPATABILITY.

This SPC floor can be installed over an embedded water-based Under Floor Heating (UFH) system.

Turn the heat off for 24 hours before, during and 24 hours after installation when installing over radiant heated subfloors.

- Before installing over newly constructed radiant heat systems, operate the system at maximum capacity to force any residual moisture from the cementitious topping of the radiant heat system. Concrete moisture vapour emissions should not exceed 8lbs ASTM F1869 or 90%RH (ASTM F2170) .
- Make sure that the temperature in the room is at least 65° F / (18.3 C) during installation.
- Floor temperature must not exceed 82°F (27.7°C).
- Once the installation has been completed, the heating system should be turned on and increased gradually (5 degree increments) until returning to normal operating conditions.
- Refer to the radiant heat system's manufacturer recommendations for additional guidance.
- Failure to strictly follow adhesive manufacturer's guidelines may result in failure and void the warranty.
- **Electric heating mats that are not embedded into the subfloor are not recommended for use underneath the floors. Using electric heating mats that are not embedded and applied directly underneath the floors will void the warranty for your floor in case of failure.**

WARRANTY

This guarantee is for replacement or refund of the SPC flooring only, no labour (including the cost of labour for installation of the replacement floor) or costs incurred with loss of time, incidental expenses or any other damage.

It does not cover damage from improper installation or maintenance, burns, tears, indentations, stains or reduction in gloss level due to normal use and or exterior applications.

The Warranty does not cover discoloration from mould or from flooding, leaking plumbing or appliances, water ingress through doorways, as well as floor covering failure due to hydrostatic pressure or moisture vapour.

Claims

This guarantee applies only to the original purchaser.

Claims for wear must show a minimum 20mm area. This guarantee is pro-rated based on the amount of time the floor has been installed. If you wish to file a claim under warranty, contact the authorized dealer where the flooring was purchased.

WARRANTY

This guarantee is for replacement or refund of the SPC flooring only, no labour (including the cost of labour for installation of the replacement floor) or costs incurred with loss of time, incidental expenses or any other damage.

It does not cover damage from improper installation or maintenance, burns, tears, indentations, stains or reduction in gloss level due to normal use and or exterior applications.

The Warranty does not cover discoloration from mould or from flooding, leaking plumbing or appliances, water ingress through doorways, as well as floor covering failure due to hydrostatic pressure or moisture vapour.

Claims

This guarantee applies only to the original purchaser.

Claims for wear must show a minimum 20mm area. This guarantee is pro-rated based on the amount of time the floor has been installed. If you wish to file a claim under warranty, contact the authorized dealer where the flooring was purchased.

PROOF OF PURCHASE IS REQUIRED FOR ALL CLAIMS.